



User Manual
August 18, 2009 - v1.1



For more information, visit our website at www.macpower.com.tw

(1) Specifications

Application	<ul style="list-style-type: none"> 5.25" SATA optical disc drive Drive length 16.5cm - 18.5cm
Interface/Ports *	<ul style="list-style-type: none"> eSATA USB 2.0 High Speed
Data Transfer *	<ul style="list-style-type: none"> eSATA up to 3.0Gbps (300MB/s) USB 2.0 up to 480Mbps (60MB/s) USB 1.1 up to 12Mbps (1.5MB/s)
System Requirements (PC)	<ul style="list-style-type: none"> eSATA: Windows XP/Vista USB 2.0: Windows XP/Vista eSATA Plug & Play support for host controller
System Requirements (Mac)	<ul style="list-style-type: none"> eSATA: Mac OS 10.4 or higher USB 2.0: Mac OS 10.2 or higher eSATA Plug & Play support for host controller
Operating Environment	<ul style="list-style-type: none"> Temperature: 5°C ~ 40°C Humidity: 10%RH ~ 80%RH
Storage Environment	<ul style="list-style-type: none"> Temperature: -20°C ~ 70°C Humidity: 5%RH ~ 90%RH
Power Supply	<ul style="list-style-type: none"> Input: AC 100-240V Output: DC +12V/2A
Enclosure Size	<ul style="list-style-type: none"> 23.6cm x 17cm x 6cm

* Note: Available interfaces and data transfer speeds depend on the model.

(2) Detailed View

The available interfaces depend on the model you have purchased.

SK-5250 USB 2.0

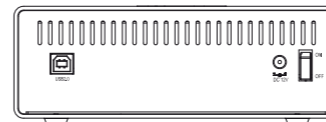

SK-5250 S2

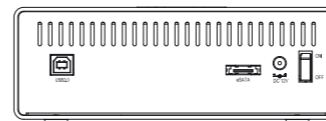

Note: Product specifications and design may change or differ from illustration at anytime without prior notice.

(3) Drive Assembly

a) Remove the screws located at the bottom of the case and pull out the chassis from the enclosure.

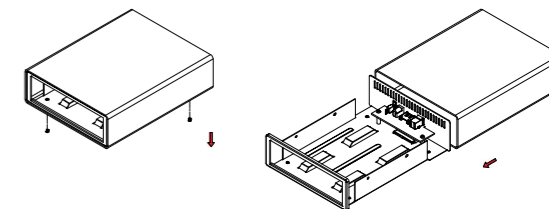

b) Install the drive, connect the SATA and power cable, and then mount the drive with the four screws from the side.

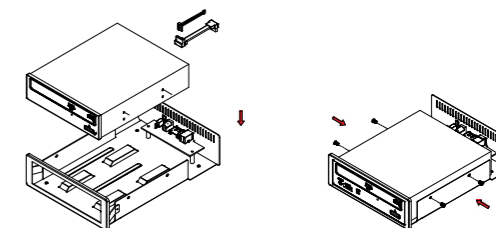

Note: Your unit may come with a pre-installed drive. Before opening your enclosure, please read the warranty carefully, as this could void it.

(4) Enclosure Assembly

a) Slide the assembled drive back into the enclosure but be careful not to damage any of the components.

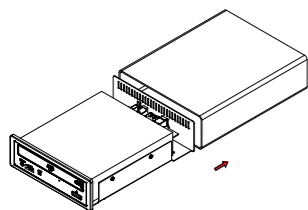

b) Fasten the 4 screws at the bottom of the casing to finish the assembly. Next, peel off the paper from the back of the self-adhesive rubber feet. Now, place the rubber feet over the screws and stick them on the casing to cover the screws.

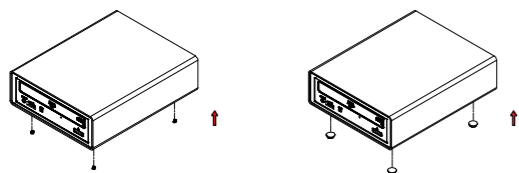

Note: Be careful not to damage any components when installing the drive!

(5) System Set Up

If the drive has been pre-installed and setup already, you do not need to prepare anything else and can use it straight out of the box.

If you have purchased an empty enclosure, make sure the drive is properly installed before you connect it to your computer and turn on the power.

- Turn on your computer and start the system.
- Plug-in the external power supply, connect the SK-5250 to the computer and turn on the power.
- The system will automatically mount the drive and you can access it under My Computer for the PC or on your desktop for the Mac.
- If the drive does not show up, make sure a DVD has been inserted and the correct drive has been selected in your media player or DVD burning software.
- For the safe removal of your drive and to assure that no data is lost, always eject the external drive from your system first, before you turn it off.

Note: When not in use for longer periods of time, it is recommended to turn off the device and unplug the power supply.

(6) Safety Information

Location and placing precautions

Do not cover the SK-5250 and do not place the unit on other heat-sensitive equipment. Avoid positioning it in the following places:

- Locations with direct sunlight, next to radiators or other sources of heat with high temperatures (more than 35° C) or high humidity (more than 90%).
- Locations subject to vibration, shock, or with a slope.
- Do not expose the product to water or humid conditions.

Electricity and power plug

Careful attention must be paid to the following points in order to avoid operational faults and electric shock or fire:

- When removing the power cable from the socket, always pull on the plug fixture and never on the cord.
- Do not touch the power cable with wet hands.
- Never try to repair or modify the power cable yourself.
- If the unit should emit smoke, an unusual odour or noise, switch it off immediately and unplug the power cable.

Cables

Use only the cables supplied or recommended by your vendor in order to avoid any sort of malfunction.

(7) FAQ

Q: Can I install a hard drive?

A: No, this enclosure is designed for optical disc drives only.

Q: Can I use my device with bus power only?

A: No, an external power supply is always required.

Q: Can I use more than one interface at the same time?

A: No, only one interface can be used at any given time. Disconnect the previous cable before connecting the new one.